

ESHH 3041 hydraulic

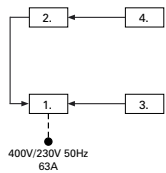

IME-AUTOLIFT
Autolift GmbH

types, arrangement



ESHH 3041 – 4 column set

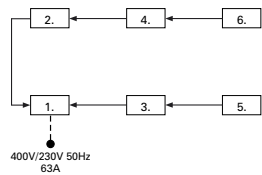

ESHH 4561 – 6 column set

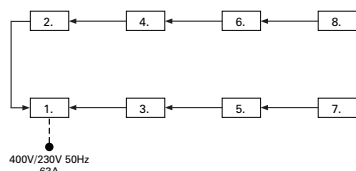

ESHH 6082 – 8 column set

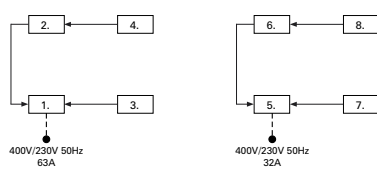

ESHH 6082 – 2 times 4 column set



mobile column lift





IME-AUTOLIFT

Autolift GmbH

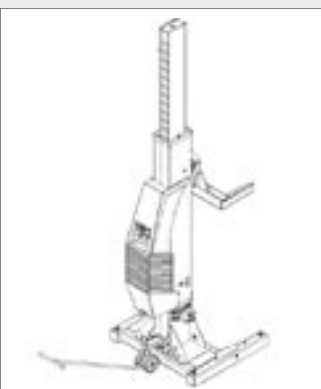
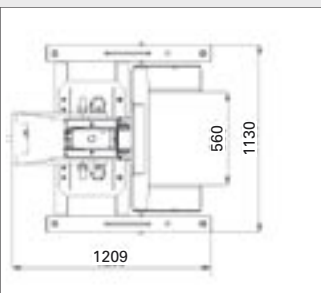
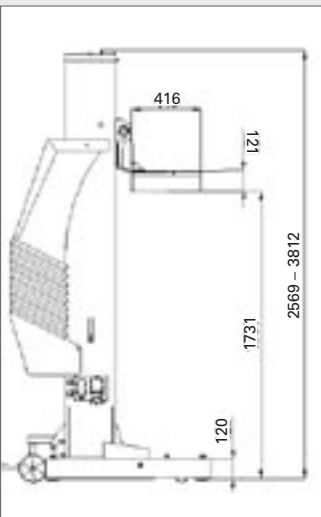

IME-AUTOLIFT hydraulic mobile column lifts are very easy, fast and smooth to operate. Longlife high technology for a fair price was essential for this construction. The long knowledge from IME-AUTOLIFT in the mobile lift business becomes here a very positive matter.

On each column you can connect the Hand Control by a quick coupling. With the Hand Control it is possible to choose and control all function, single or pair operation or synchronized group operation with 4, 6 or 8 columns.

This is until now exclusive by IME-AUTOLIFT and the worldwide users are very impressed of this system.



hand control



signal lights, emergency stop and connection plug for handcontrol on all columns

options



adjustable trolle



axle stands



hydraulic trolley



trailer traverse

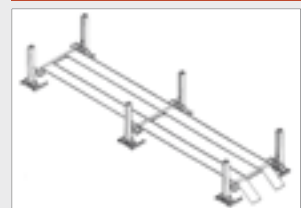

ramps

Autolift GmbH

Mayrwiesstraße 16
5300 Hallwang/Salzburg
Tel.: +43 662 - 45 05 88
Fax: +43 662 - 45 05 88 - 18
Mail: office@autolift.info
Web: www.autolift.info

technical data

	ESHH 3041 hydraulic	ESHH 4561 hydraulic	ESHH 6082 hydraulic
lifting weight	4 x 7,5 t = 30 t	6 x 7,5 t = 45 t	8 x 7,5 t = 60 t
height of stroke	1731	1731	1731
lifting time	90 sec	90 sec	90 sec
energy demand	4 x 2,2 KW	6 x 2,2 KW	8 x 2,2 KW
voltage	3 x 400 V/50 Hz	3 x 400 V/50 Hz	3 x 400 V/50 Hz